

Event Title  
Date  
Time  
Location  
25Live #:  
WO #:

**SET-UP:**

Standard stage & podium as shown  
180 Chairs as indicated  
1 - 6' table with 2 chairs for check in  
4 - 6' tables on the southeast corner  
Trash/Compost/Recycle as indicated  
10 – extra chairs in NCEC Kitchen

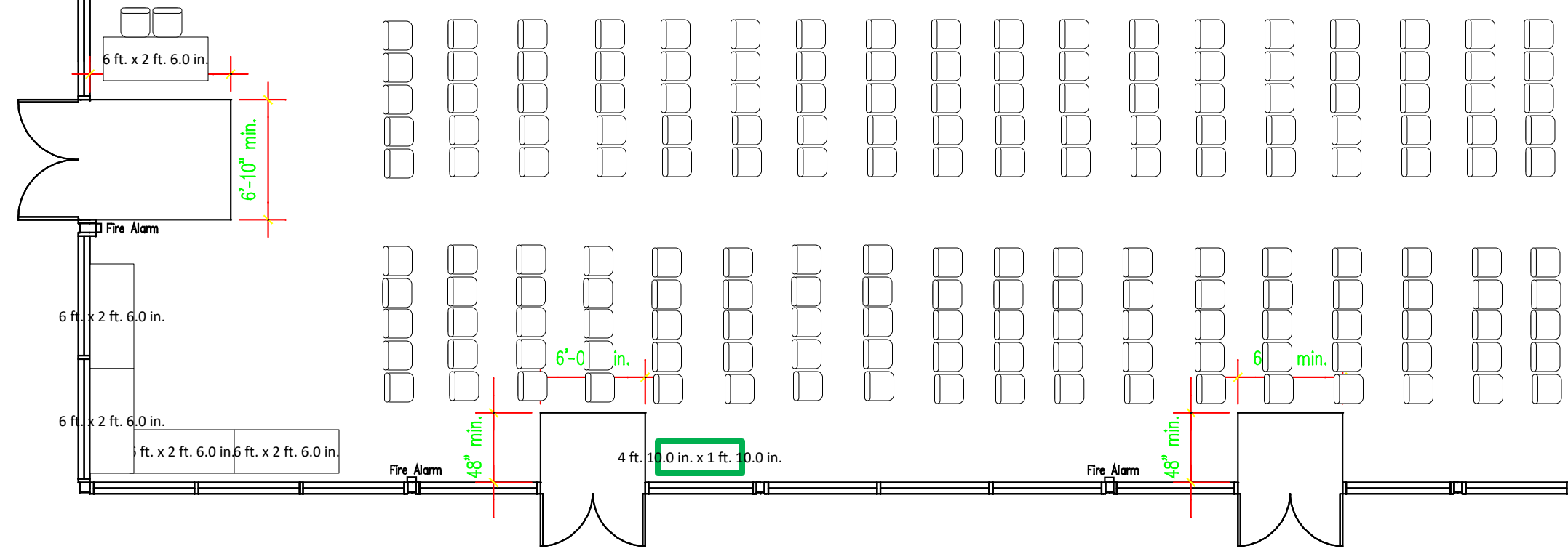
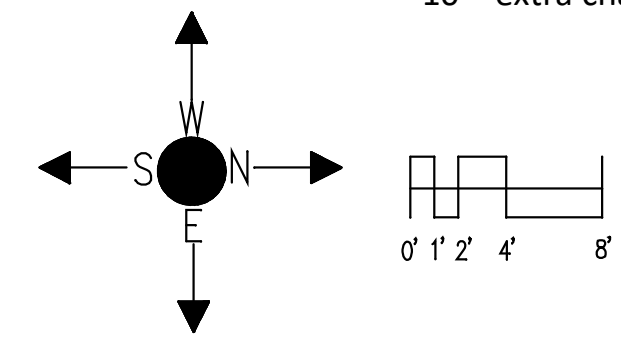

Please note that this diagram conforms to the Fire Safety Codes and ADA rules at its stated capacity for this space. Any changes to this diagram/set-up now or at the actual event, must be approved by Event & Conference Services (425-352-3556). Facilities staff is not allowed to change this diagram/set-up or to obtain additional furniture unless it is approved by Event & Conference Services (425-352-3556). It is the patron's responsibility to assure compliance with the Fire Safety Codes and ADA rules throughout and during their event.